



Sheepwash Row, Rugeley, WS15 2UX

£259,950

 2  1  2



**** ONLINE VIRTUAL TOUR AVAILABLE ON THIS PROPERTY - why not take a peek before booking a viewing****

Key Features

- SOUGHT AFTER LOCATION
- TRADITIONAL MID TERRACED COTTAGE
- TWO RECEPTION ROOMS
- CLOAKROOM/ UTILITY ROOM
- OFF ROAD PARKING TO REAR
- SET WITHIN THE HEART OF CANNOCK CHASE
- TWO BEDROOMS
- KITCHEN
- LARGE REAR GARDEN
- VIEWING ESSENTIAL

Approx Gross Internal Area
71 sq m / 769 sq ft

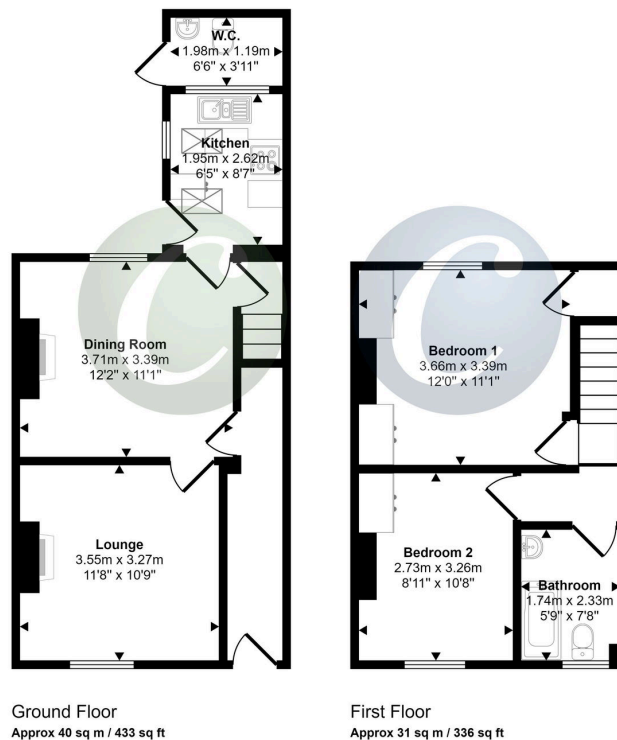

This floorplan is only for illustrative purposes and is not to scale. Measurements of rooms, doors, windows, and any items are approximate and no responsibility is taken for any error, omission or mis-statement. Icons of items such as bathroom suites are representations only and may not look like the real items. Made with Made Snappy 360.